

FAU RTE	SECTION	COUNTY	TOTAL SHEETS	SHEET NO.
1247	00-00084-00-RS	LAKE	39	38
F.H.W.A. REG.		ILLINOIS	PROJECT M-8003 (147)	

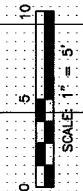
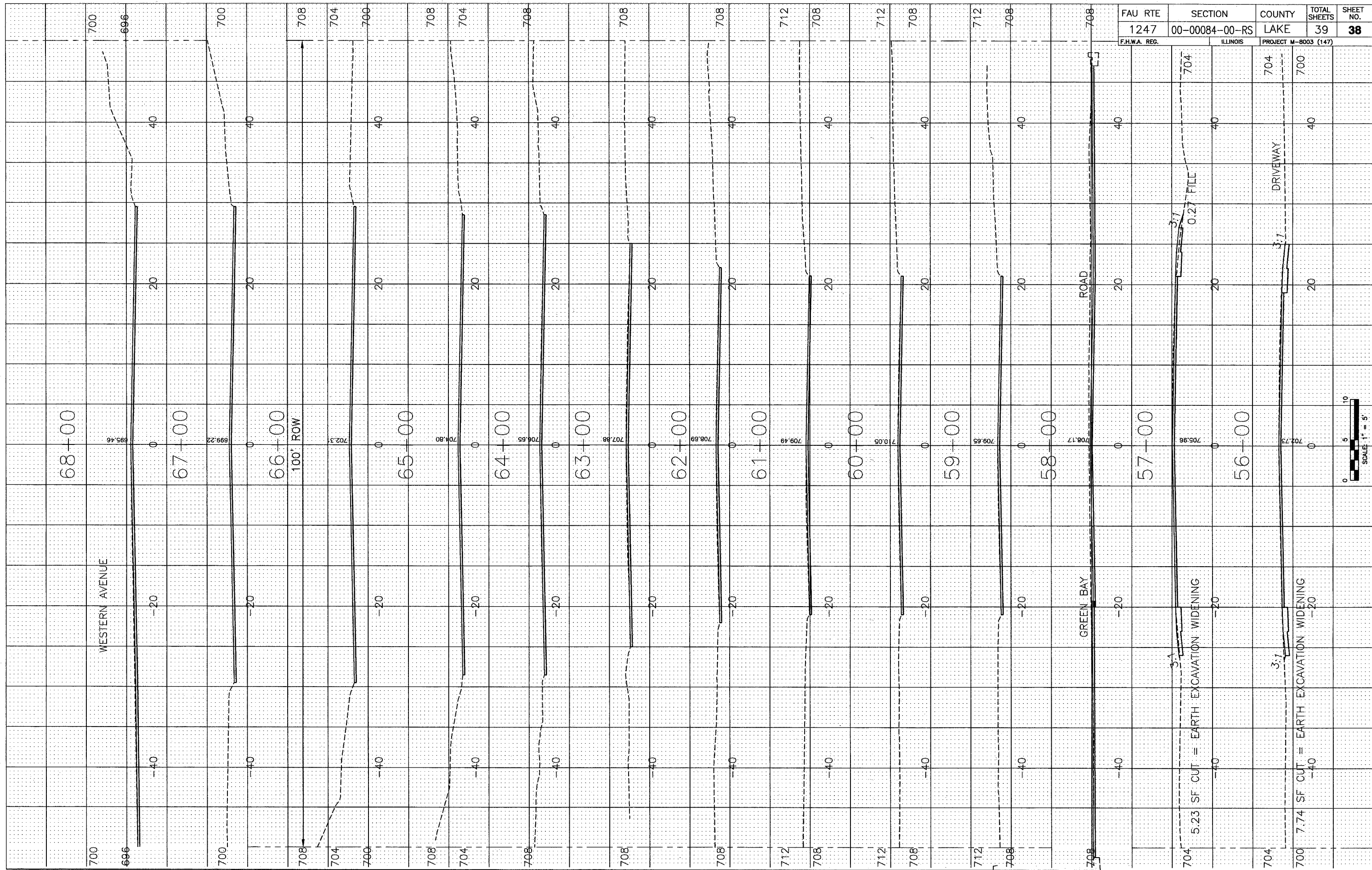

REVISIONS		
NO.	ITEM	DATE

SCALE:	1" = 5" HORZ. & VERT.
DRAWN BY:	MS
CHECKED BY:	CAM
DATE:	1-23-04

McCLURE ENGINEERING ASSOCIATES, INC.
 2728 Grand Ave., Waukegan, IL 60085 Design Firm License: Illinois #184-000816
 TEL 847-336-7100 FAX 847-336-7155 Copyright 2004 by
 EMAIL: wk@mcclureengineering.com McClure Engineering Associates, Inc.

CROSS SECTION SHEET
WESTLEIGH ROAD IMPROVEMENTS
 THE CITY OF LAKE FOREST JOB NUMBER: 02-28-02-007 LAKE COUNTY, ILLINOIS
 M:\dwg\LF\Westleigh\WEST-XSEC.dwg 03/27/2002 09:25:34 AM CST