

83740

MATCH LINE STA. 66+50
SEE SHEET 19

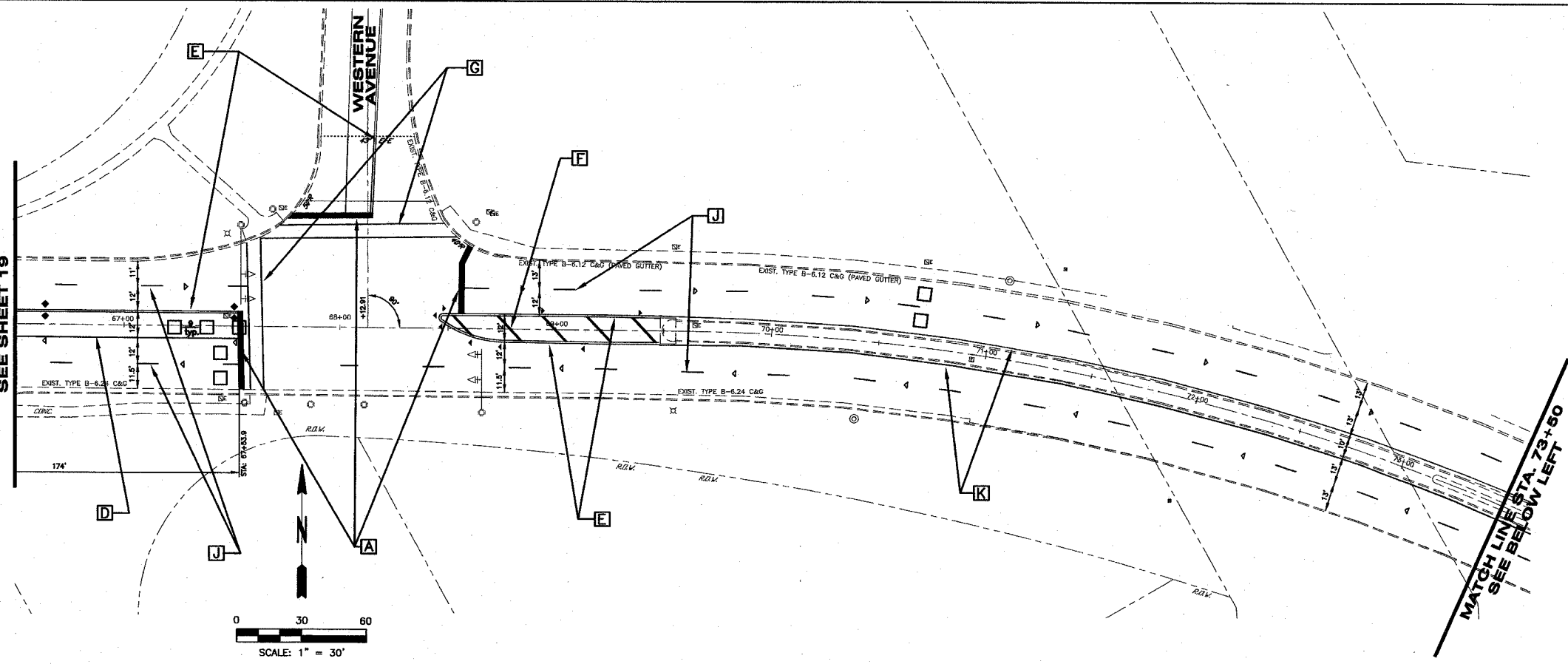

LEGEND

- | | |
|--|--|
| A THERMOPLASTIC PAVEMENT MARKING LINE, 24" STOP BAR, WHITE | F THERMOPLASTIC PAVEMENT MARKING LINE, 12" DIAGONAL 45°, 15' C-C, YELLOW |
| B THERMOPLASTIC PAVEMENT MARKING LINE, 6" 2' DASH, 6" SKIP, WHITE | G THERMOPLASTIC PAVEMENT MARKING LINE, 12" CROSSWALK, WHITE, WIDTH TO MATCH WALKWAY |
| C THERMOPLASTIC PAVEMENT MARKING LINE, 4" WHITE | H THERMOPLASTIC PAVEMENT MARKING LETTERS & SYMBOLS |
| D THERMOPLASTIC PAVEMENT MARKING LINE, 6" WHITE | I THERMOPLASTIC PAVEMENT MARKING LINE, 4" 10' DASH, 30' SKIP, YELLOW |
| E THERMOPLASTIC PAVEMENT MARKING LINE, 4" 11" C-C, DOUBLE YELLOW | J THERMOPLASTIC PAVEMENT MARKING LINE, 4" 10' DASH, 30' SKIP, WHITE |
| | K THERMOPLASTIC PAVEMENT MARKING LINE, 4" YELLOW |

MATCH LINE STA. 73+50
SEE BELOW LEFT

6' x 6' TYPE 1 DETECTOR LOOP TO BE SPLICED TO EXISTING LEAD-IN CABLE. CONTRACTOR SHALL VERIFY LOCATION OF EXISTING LOOP CONFIGURATION AND LEAD-IN CABLE PRIOR TO DETECTOR LOOP INSTALLATION. ALL FIELD VERIFICATION AND SUBSEQUENT CONNECTIONS SHALL BE CONSIDERED INCIDENTAL TO THE COST OF THE TYPE 1 DETECTOR LOOPS.

RAISED REFLECTIVE PAVEMENT MARKER LEGEND

▶	ONE WAY AMBER MARKER
▷	ONE WAY CRYSTAL MARKER
◆	TWO WAY AMBER MARKER

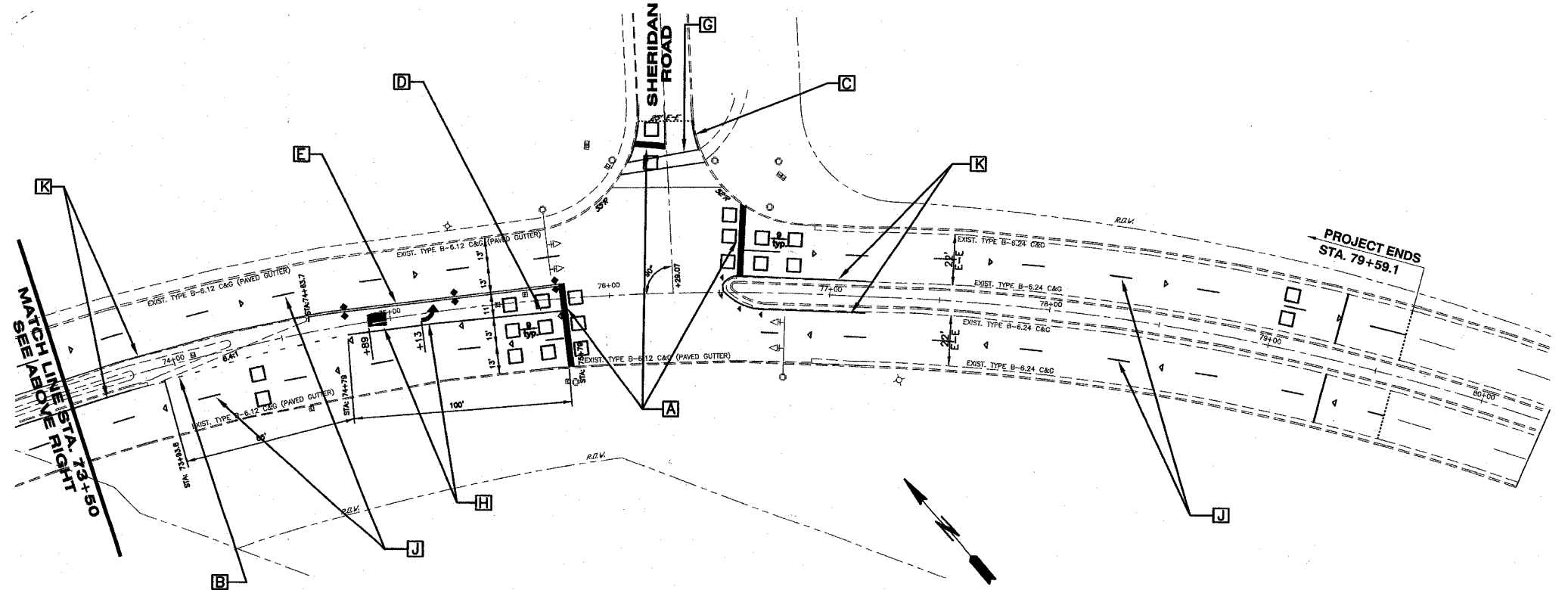

PROJECT ENDS
STA. 79+59.1

MATCH LINE STA. 73+50
SEE ABOVE RIGHT

REVISIONS		
NO.	ITEM	DATE

SCALE: 1" = 30'
DRAWN BY: MS
CHECKED BY: CAM
DATE: 1-23-04

McCLURE ENGINEERING ASSOCIATES, INC.
2728 Grand Ave. Waukegan, IL 60085 Design Firm License: Illinois #184-000816
TEL 847-336-7100 FAX 847-336-7155 Copyright 2004 by
EMAIL wk@mcclureengineering.com McClure Engineering Associates, Inc.

STRIPING PLAN
WESTLEIGH ROAD IMPROVEMENTS
THE CITY OF LAKE FOREST JOB NUMBER: 02-28-02-007 LAKE COUNTY, ILLINOIS
M:\dvg\LF\Westleigh\STRIPING.dwg 03/28/2002 11:33:09 AM CST