

F.A. RTE.	SECTION	COUNTY	TOTAL SHEETS	SHEET NO.
*	2003-0778	COOK	25	10
STA.		TO STA.		
FED. ROAD DIST. NO.	ILLINOIS	FED. AID PROJECT		
* FAP 358/FAU 2943				62645

**LEGEND**

- ① 4" DOUBLE SOLID YELLOW CENTERLINE
  - ② 24" SOLID WHITE BAR STOP
  - ③ 6" SOLID WHITE TURN LANE LINE
  - ④ 4" SKIP DASH WHITE LANE LINE (10' DASH 30' SKIP)
  - ⑤ 12" SOLID YELLOW DIAGONAL LINES (70' C-C SPACING)
  - ⑥ 4" SOLID WHITE EDGE LINES
  - ⑦ CROSSWALK LINES; 2 @ 6" WHITE, 6' C-C
  - ⑧ 8" SOLID WHITE MEDIAN ISLAND LANES
- \* ALL PAVEMENT MARKINGS ARE WITH THERMOPLASTIC.

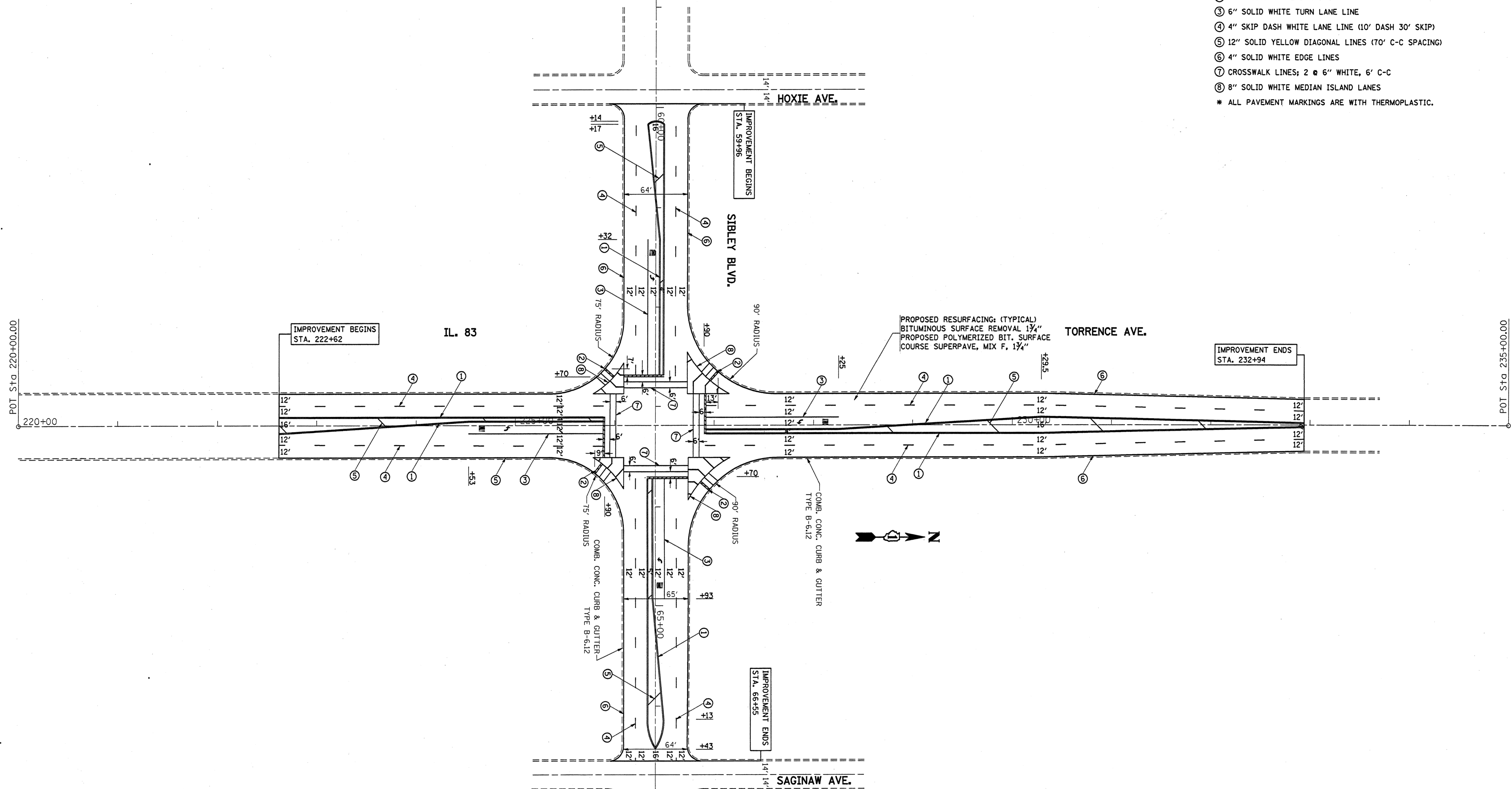

REVISIONS	
NAME	DATE

ILLINOIS DEPARTMENT OF TRANSPORTATION

LOC. 1: IL. 83 AT SIBLEY BLVD.  
ROADWAY AND PAVEMENT  
MARKING PLANS

SCALE: VERT. 1"=50'  
HORIZ. 1"=50'

DATE: 11/06/2003

DRAWN BY  
CHECKED BY

11/06/2003 11:17:36